

**ENG Range**

- Sizes from 75 mm to 225 mm (2½" - 8").

**Standards**

- Available Standards: ISO/DIN, ANSI/ASTM.

**Working pressure**

- At 20°C D75-D140 (2½" - 5") PN10 (150 PSI@73°F)
- D160-D225 (6" - 8") PN 6 (90 PSI @ 73°F)

**Features**

- Requires little space in piping systems.
- Easy installation: wafer body slips between standard flanges. No gaskets required.
- Vertical and horizontal operation.
- Available with EPDM or Viton® O-Rings.
- Excellent flow characteristics.

# Swing check valves Clapets à battant Válvulas de clapeta Válvulas de clapeta



## Materials / Matériaux / Materiales / Materiais

**FRA Dimensions**

- Du D75 mm au D225 mm (2½" - 8").

**Standards**

- Standards disponibles: ISO/DIN, ANSI/ASTM.

**Pression de service**

- A 20°C D75-D140 (2½" - 5") PN 10 (150 PSI@73°F)
- D160-D225 (6" - 8") PN 6 (90 PSI @ 73°F)

**Caractéristiques**

- Faible encombrement.
- Facile d'installation: se monte entre deux brides standards.
- S'utilise indifféremment en position verticale ou horizontale.
- Joints en EPDM ou Viton®.
- Excellentes caractéristiques de conduction.

**ESP Medidas**

- Desde 75 mm a 225 mm (2½" - 8").

**Standards**

- Standards disponibles: ISO/DIN, ANSI/ASTM.

**Presión de servicio**

- A 20°C D75-D140 (2½" - 5") PN 10 (150 PSI@73°F)
- D160-D225 (6" - 8") PN 6 (90 PSI @ 73°F)

**Características**

- Requiere poco espacio en la instalación.
- Fácil instalación: se monta entre bridas standard.
- Instalación vertical y horizontal.
- Junta de la clapeta en EPDM o Viton®.
- Excelentes características de conducción.

**POR Medidas**

- Desde 75 mm a 225 mm (2½" - 8").

**Standards**

- Standards disponíveis: ISO/DIN, ANSI/ASTM.

**Pressão de serviço**

- A 20°C D75-D140(2½" - 5") PN 10 (150 PSI@73°F)
- D160-D225 (6" - 8") PN 6 (90 PSI @ 73°F)

**Características**

- Requiere pouco espaço na instalação.
- Fácil instalação: monta-se entre flanges standard.
- Instalação vertical ou horizontal.
- Junta em EPDM ou Viton®.
- Excelentes características de condução.

**ENG Parts**

1. Body
2. Flap
3. Cap
4. Body O-ring
5. Flap O-ring

**FRA Pièces**

1. Corps
2. Battant
3. Bouchon
4. Joint du corps
5. Joint battant

**ESP Despiece**

1. Cuerpo
2. Clapeta
3. Tapón
4. Junta cuerpo
5. Junta clapeta

**POR Peças**

1. Corpo
2. Clapeta
3. Tampão
4. Junta corpo
5. Junta clapeta

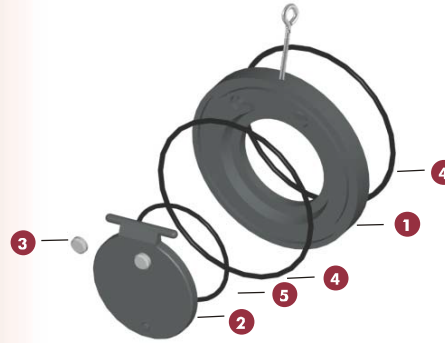

- 1 2 PVC-U
- 3 PP
- 4 5 EPDM / Viton®

## Dimensions / Dimensions / Dimensiones / Dimensões

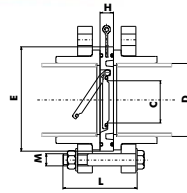

D	C	H	E	M x L
mm "	mm "	mm "	mm "	mm "
75 / 2 ½"	40	1.57	20	0.79 129 5.08 16x120 0.63x4.72
90 / 3"	52	2.05	20	0.79 144 5.67 16x120 0.63x4.72
110 / 4"	70	2.76	22	0.87 164 6.46 16x120 0.63x4.72
125 / 4 ½"	83	3.27	25	0.98 170 6.69 16x130 0.63x5.12
140 / 5"	92	3.62	24	0.94 195 7.68 16x130 0.63x5.12
160 / 6"	112	4.41	26	1.02 220 8.66 20x160 0.79x6.30
200 / 7"	139	5.47	28	1.10 247 9.72 20x160 0.79x6.30
225 / 8"	150	5.91	34	1.34 275 10.83 20x160 0.79x6.30

## Pressure / Temperature Graph Diagramme Pression / Température Diagrama Presión / Temperatura Diagrama Pressão / Temperatura

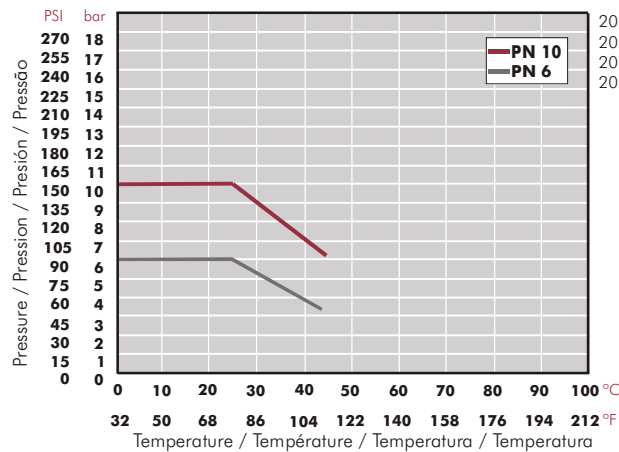

- 20 years / water flow
- 20 années / fluide de l'eau
- 20 años / fluido agua
- 20 anos / caudal de água



Lluís Companys, 51-53 - 08400 Granollers (Barcelona) Spain  
Tel. + (34) 93 870 42 08 - Fax + (34) 93 870 98 11  
E-mail: cepex@cepex.com  
Website: www.cepex.com